



**10-year**  
mechanical  
warranty

**5-year**  
electrical

Hinged worktop mechanism  
provides easy access for  
maintenance



# Credenza V3

Credenza is an audio visual integrated free standing cabinet. Ideal for mid-sized seminar rooms, the unit sits against the wall to be inconspicuous and efficiently utilise space.

Utilising our 16U rack design, which secures both rack and non-rack mounted equipment, Credenza range is supplied with a wide range of door options, a flexible monitor arm and either standard steel sides or wooden and fabric panels at additional cost.

**Features**

- Single (16U) or double (32U) rack space
- Front and rear door rack access
- Steel, wooden or fabric side panels
- Wide range of door options



**Utilise any sized space**

Sits against the wall to be inconspicuous and efficiently utilise space.



**Secure your AV equipment**

Robust steel construction and drill resistant locks ensure security.



**Seamless AV integration**

Complete internal cable management creates an 'all-in-one' solution.

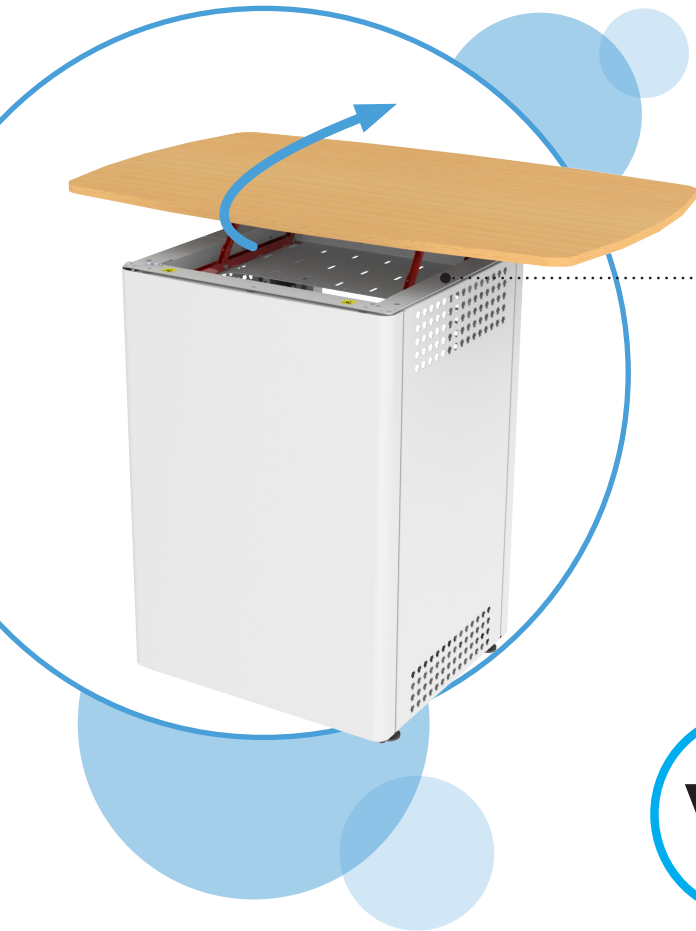

Hinged worktop mechanism provides easy access for maintenance and space for power adaptors

Power strip situated in top cable well for improved access

**V3**

Removable side panels for 360° access

Removable front and rear doors for easy maintenance

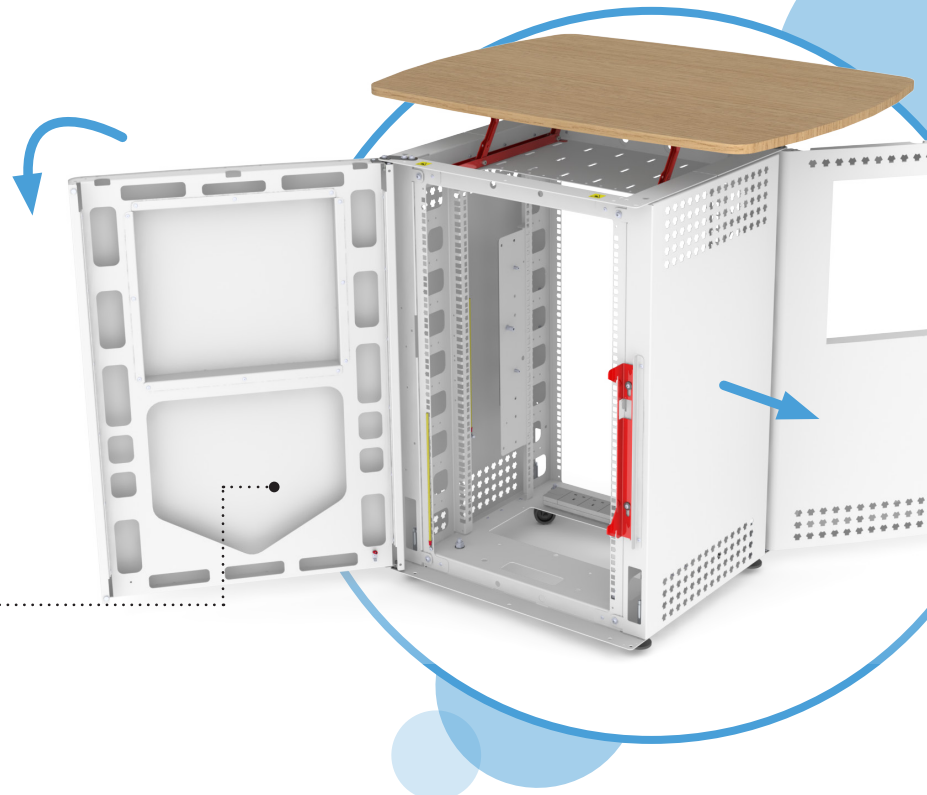

## Models

	Standard	Deluxe
Mono	E3CMS16U-XX	E3CMF16U-XX
Duplex	E3CDXS16U-XX/XX	E3CDXF16U-XX/XX

## Included

Rack shelves are no longer supplied as standard. They remain available free of charge on request.

- Standard paint, worktop & edge banding finishes
- Choice of Solid / Half Open / Half Glazed / Fully Glazed door options
- 16U or 32U rack space – Half U's open in door (standard)
- Concealed castors
- Monitor arm (ENDO72 or 82)
- Worktops are supplied with a thickness of 25mm

## Additional cost

- Non-standard paint, worktop & edge banding finishes
- Wooden or fabric side panels
- Visualiser housing
- Control panel housing
- Writing surface inlay
- Vinyl branding / wrap
- Printed branding
- Desktop machining

## Dimensions

Mono

H: 953mm      W: 740mm      D: 641mm

Duplex

H: 953mm      W: 1440mm      D: 641mm

## Standard paint finishes



## Standard worktop & edge banding finishes

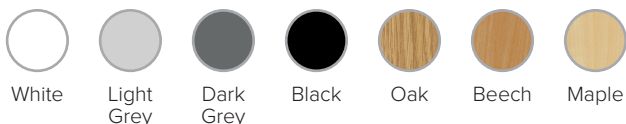

## Make it your own!

We offer a wide range of non standard colours and finishes. Custom colours can be supplied at standard pricing but may incur an additional cost.

