

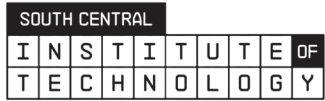

TOP-TEC Case Study:

South Central Institute of Technology

Creating an innovative learning hub...



Creating an innovative learning hub...

The goal of the South-Central Institute of Technology (SCIoT) is to transform education by establishing learning environments that adhere to contemporary teaching methods and cater to the requirements of various industries.

In partnership with MK College, this exciting project involved a new building at Bletchley Campus in Milton Keynes with the aim of providing opportunities for education and training in crucial tech skills, meeting the needs of businesses and inspiring digital futures.

The institute wanted to make one of the rooms in the new building into a dynamic collaborative learning space, designed to promote teamwork and enhance student engagement. To achieve this vision, TOP-TEC collaborated with Roche AV to help bring SCIoT's innovative learning environment to life.

Key Project Criteria for the SCIoT project:

- Blending physical and digital environments.
- Integrated learning and collaboration.
- Agile and adaptable spaces.

Project brief for TOP-TEC:

- Facilitate, secure, and integrate the preselected AV/ICT equipment.
- Incorporate SCIoT branding within the new space.

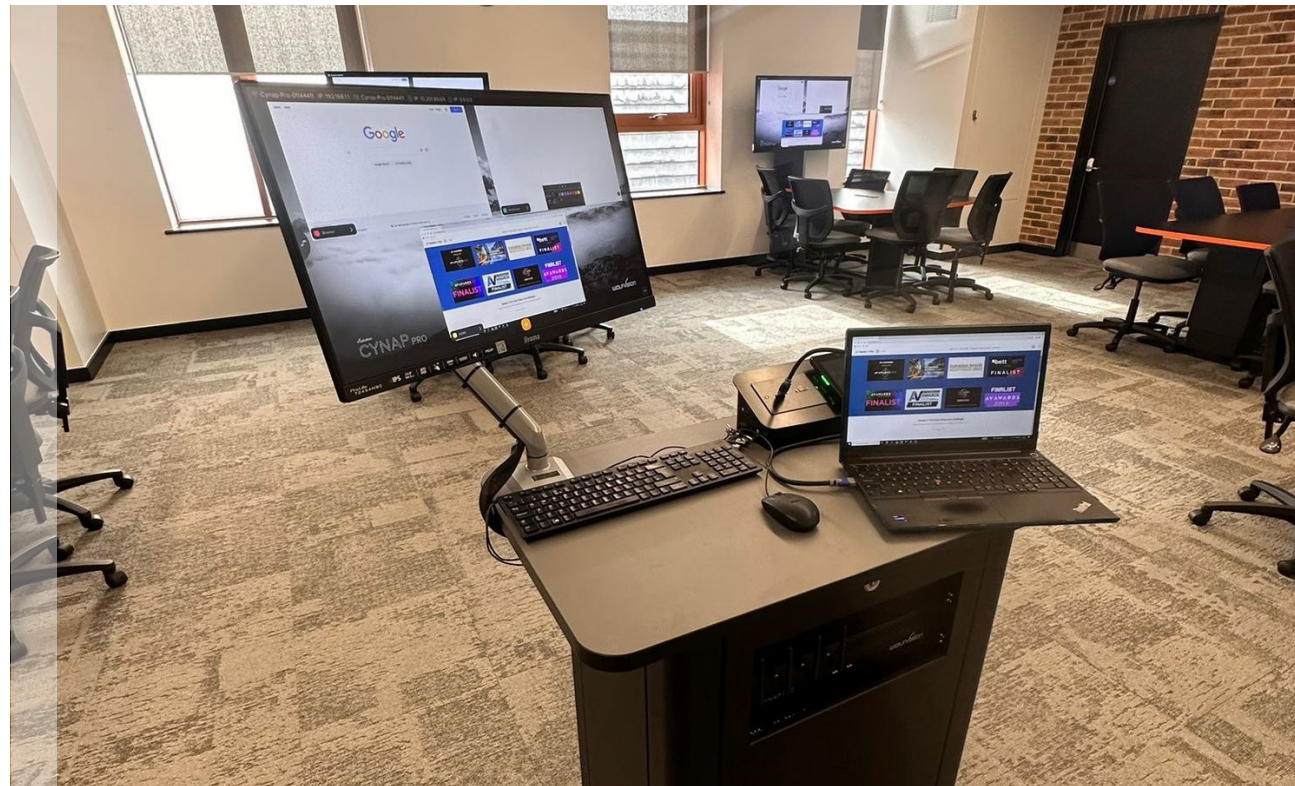

Decision Process

Following several project meetings between TOP-TEC, Roche AV and SCIoT, we decided our Synergy collaborative tables would be the best solution for the new learning environment. SCIoT appreciated how the Synergy range would help support their objective of integrating learning and collaboration into the brand new building.

To help maximise the space within the room, TOP-TEC worked with Roche AV and SCIoT to develop 2D room layouts featuring the Synergy Plectrum and Synergy Quad, helping provide a working space for up to 30 students. Once a layout was agreed upon, 3D room renders were then supplied to help SCIoT fully visualise what the new space would look like.

The Plectrum and Quad worktop shapes were decided upon as both promote collaboration between students, whilst using the screen as an aid for group work.

SCIoT were keen on implementing their brand throughout the new campus space and discussed how we could work together to achieve this. Liaising with the chosen architects, we were able to provide some 3D renders of how each product would look incorporating SCIoT's orange and black colourways.

Flexible Learning Spaces

Our Synergy tables provide the perfect space for traditional group collaboration or for students working flexibly, utilising the second screen.



Collaboration tables for 30 students
Synergy Plectrum and Quad (6-seat)



Lecturer's lectern station to
control AV within the space
Rubi Mono



How did we help?

○ *“Blending Physical and Digital Environments”*

Our Synergy tables feature a screen at the end of the table that can facilitate video conferencing, online and blended learning, enabling online students to work alongside students physically seated at the table, giving lectures a choice of how to teach the class.

○ *“Integrated learning and collaboration”*

Synergy is specifically designed to enhance student communication and teamwork, ideal for collaborative learning spaces such as this one. Additionally, when the screen is not used for hybrid group work or casting content, the plectrum and quad worktop shapes naturally point towards the front of the room so that the lecturer can provide traditional classroom teaching if required on the day, giving tutors the tools to teach however the like.

○ *“Facilitate, secure, and integrate the preselected AV/ICT equipment”*

Here at TOP-TEC, we consider AV/IT from the start, rather than as an afterthought and can tailor our solutions to seamlessly integrate AV and IT creating an easy to use all-in-one solution. Internal cable management, worktop power options, secure PC cages and screen mounts result in a fully integrated solution for an improved user experience.

TOP-TEC were able to collaborate with Roche AV to take all of the recommended AV equipment and integrate it into our Synergy tables and Rubi AV lectern.

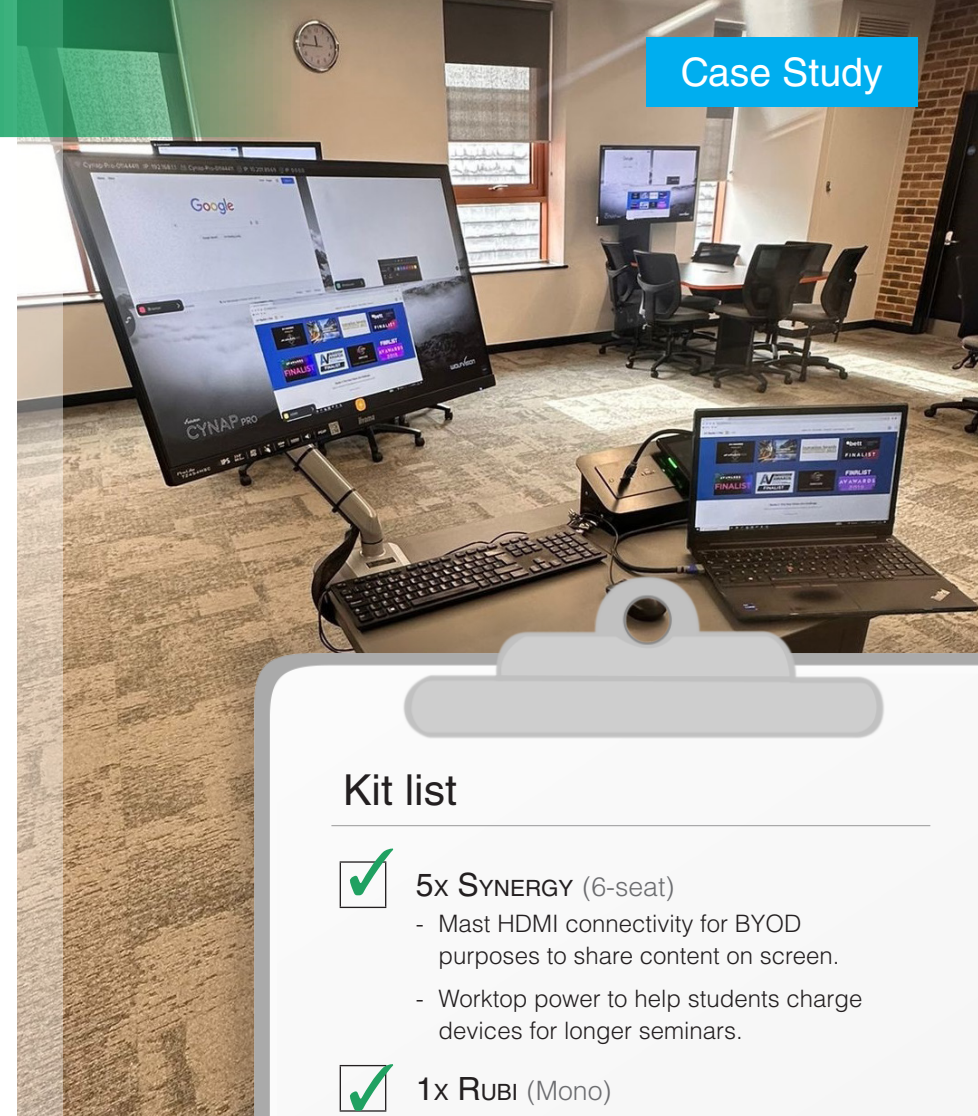

Kit list

- ✔ **5x SYNERGY (6-seat)**
 - Mast HDMI connectivity for BYOD purposes to share content on screen.
 - Worktop power to help students charge devices for longer seminars.
- ✔ **1x RUBI (Mono)**
 - Control panel housing for easy worktop connectivity (2x HDMI + control panel).
 - Lectures can quickly connect their laptop and cast content to each screen saving time at the start of lessons.
 - Ergonomic monitor arm can be moved to the ideal viewing position for each individual lecturer.
 - 16U (horizontal/350mmD) | 5U (vertical 500mmD) rack space.
 - 4Us open for secure access to AV to reduce the chance of cable tampering.





Collaborative Teaching and Learning Space

Content can be cast directly from the lecturer's screen on our Rubi to the screens on our Synergy to help improve student-lecturer engagement during classes

The Result

Since the launch of the brand new building, SCloT is now home to over 1000+ learners within the campus space, we have received some great feedback from lecturers and students who have been using the room for a variety of courses.

The colourways really give the wow factor when you walk into the room and it gives students a professional space for education and training in crucial tech skills, meeting the needs of businesses and inspiring digital futures. SCloT were happy with how we were able to provide solutions that helped support their overall goal of providing blending physical and digital environments into the brand new building.

"We are absolutely delighted with the solution provided for our Agile Learning space.

The TOP-TEC AV furniture not only looks fantastic but gives teachers and students a brilliant environment for collaboration!"

Lynette Potgieter
Milton Keynes College

We were delighted to collaborate with Roche AV on this exciting project, make sure to check out their [case study here](#).



Looking for a similar solution?
Book your **FREE** consultation today...

T: +44 (0)121 783 3838
E: sales@dalen.co.uk
W: www.top-tec.co.uk



Integrator:

T: +44 (0)142 231 0193
E: consult@rocheav.co.uk
W: www.rocheavpro.co.uk